

# CHARLESTON FIRE DEPT. CHARLESTON, NY

*BID 06999*

## D151 COMMERCIAL TANKER INTERNATIONAL 7400 2DR 4X2 CHASSIS

1250 GPM HALE QFLO PUMP		HOSE LOAD:	
1500 GALLON WATER TANK		55 CU. FT. MIN.	
COMP.T.	OPENING	INTERIOR DIMENSION	
L1/R1	35W 41H	37W 3H 12D	UPPER LOWER
L2/L3/R2/R3	37W 12H	37W 34H 22D	
L4/R4	36W 41H	38W 3H 12D	UPPER LOWER
B1	38W 43H	38W 34H 22D	
		40W 52H	24D

THIS DRAWING IS FOR REFERENCE PURPOSES. ALL DIMENSIONS ARE SUBJECT TO MINOR VARIATIONS DUE TO MANUFACTURING PROCESSES.

This print is the property of Emergency One, Inc. and is loaned to you subject to return on demand, unless otherwise agreed to in writing by Emergency One, Inc. Its contents are confidential and must not be copied or submitted to third parties for use or examination.

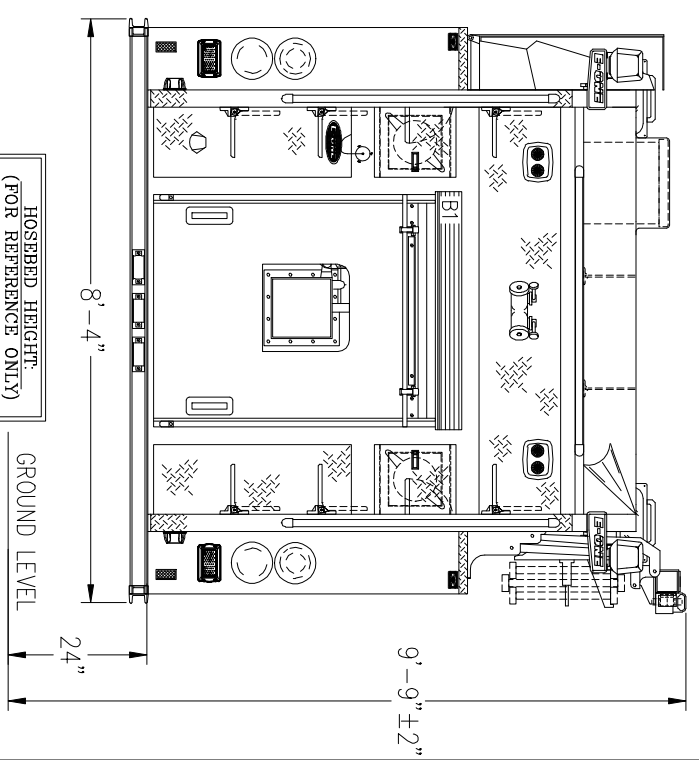
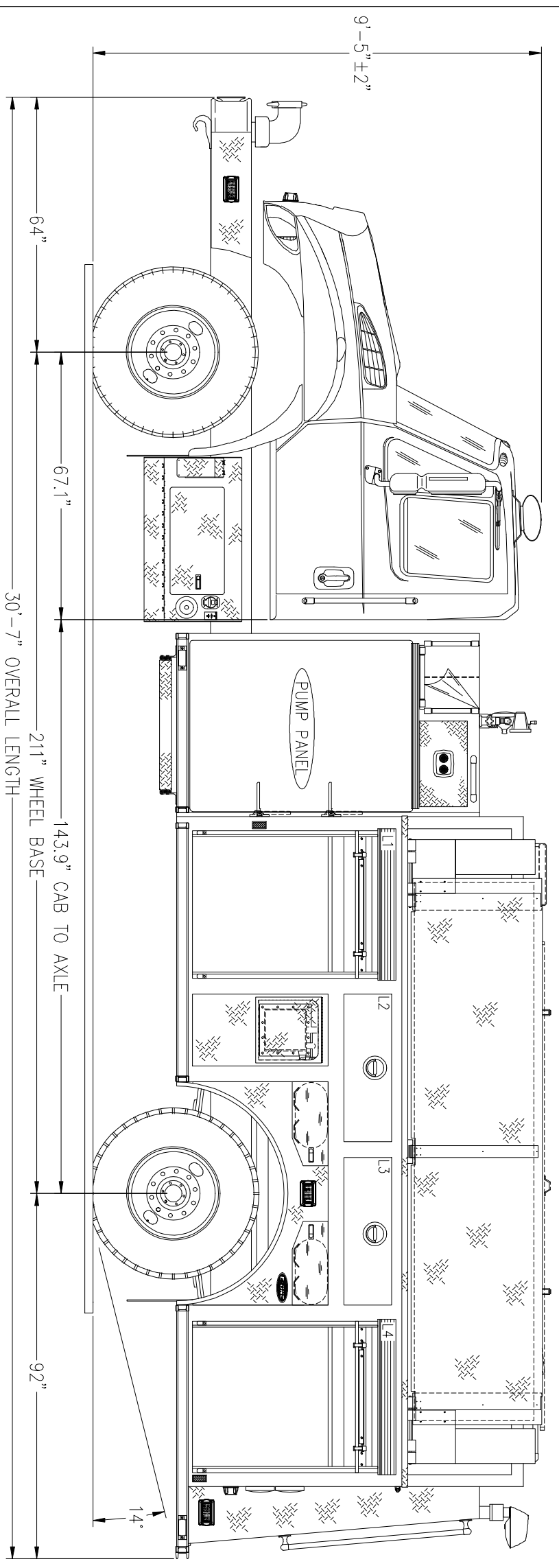
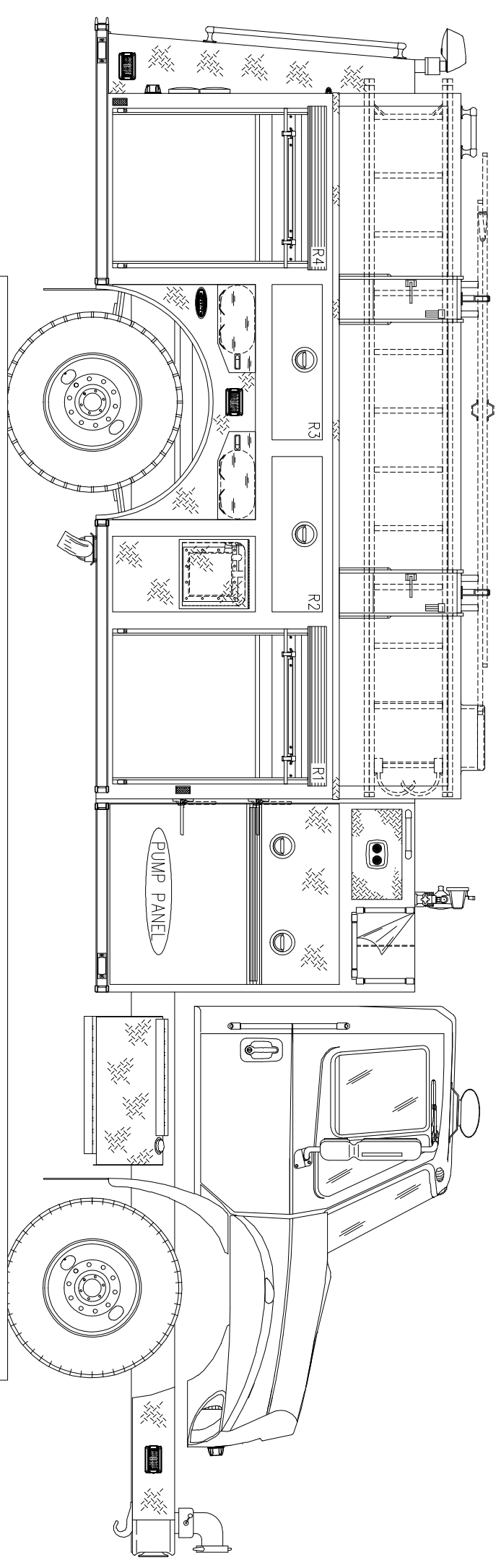

HOSBERG HEIGHT:  
(FOR REFERENCE ONLY)  
TO TAILBOARD: 75"  
TO GROUND: 99"

REV	DATE	DESCRIPTION	BY	CHKD
01	2006-04-14			
02	2006-04-14			
03	2007-03-07			
04	2007-03-07			
05	2007-03-07			
06	2007-03-07			
07	2007-03-07			
08	2007-03-07			
09	2007-03-07			
10	2007-03-07			
11	2007-03-07			
12	2007-03-07			
13	2007-03-07			
14	2007-03-07			
15	2007-03-07			
16	2007-03-07			
17	2007-03-07			
18	2007-03-07			
19	2007-03-07			
20	2007-03-07			
21	2007-03-07			
22	2007-03-07			
23	2007-03-07			
24	2007-03-07			
25	2007-03-07			
26	2007-03-07			
27	2007-03-07			
28	2007-03-07			
29	2007-03-07			
30	2007-03-07			
31	2007-03-07			
32	2007-03-07			
33	2007-03-07			
34	2007-03-07			
35	2007-03-07			
36	2007-03-07			
37	2007-03-07			
38	2007-03-07			
39	2007-03-07			
40	2007-03-07			
41	2007-03-07			
42	2007-03-07			
43	2007-03-07			
44	2007-03-07			
45	2007-03-07			
46	2007-03-07			
47	2007-03-07			
48	2007-03-07			
49	2007-03-07			
50	2007-03-07			
51	2007-03-07			
52	2007-03-07			
53	2007-03-07			
54	2007-03-07			
55	2007-03-07			
56	2007-03-07			
57	2007-03-07			
58	2007-03-07			
59	2007-03-07			
60	2007-03-07			
61	2007-03-07			
62	2007-03-07			
63	2007-03-07			
64	2007-03-07			
65	2007-03-07			
66	2007-03-07			
67	2007-03-07			
68	2007-03-07			
69	2007-03-07			
70	2007-03-07			
71	2007-03-07			
72	2007-03-07			
73	2007-03-07			
74	2007-03-07			
75	2007-03-07			
76	2007-03-07			
77	2007-03-07			
78	2007-03-07			
79	2007-03-07			
80	2007-03-07			
81	2007-03-07			
82	2007-03-07			
83	2007-03-07			
84	2007-03-07			
85	2007-03-07			
86	2007-03-07			
87	2007-03-07			
88	2007-03-07			
89	2007-03-07			
90	2007-03-07			
91	2007-03-07			
92	2007-03-07			
93	2007-03-07			
94	2007-03-07			
95	2007-03-07			
96	2007-03-07			
97	2007-03-07			
98	2007-03-07			
99	2007-03-07			
100	2007-03-07			